

Owner _____

Date _____

© 2003 C4D DESIGNS

- EQUIPMENT IN ATTIC (IN ACCORDANCE WITH THE HOUSTON AMENDED 2000 IRC)
- 1) FLOOR STAIRWAY WITH A CLEAR OPENING NOT LESS THAN 22 INCHES IN WIDTH AND A LOAD CAPACITY OF NOT LESS THAN 350 POUNDS.
 - 2) PASSAGEWAY NOT LESS THAN 30 INCHES HIGH AND 22 INCHES WIDE AND NOT MORE THAN 20 FEET IN LENGTH (CENTRAL LINE FROM THE OPENING TO THE APPLIANCE)
 - 3) PASSAGEWAY SOLID FLOORING WITH CHAPTER 5 OF THE IRC AND NOT LESS THAN 24 INCHES WIDE
 - 4) A LEVEL SERVICE SPACE AT LEAST 30 INCHES DEEP AND 30 INCHES WIDE
 - 5) CLEAR ACCESS OPENING DIMENSIONS SHALL BE A MIN. OF 20 INCHES BY 30 INCHES

IF ANY ATTIC AREAS ARE NOT ACCESSIBLE BY THE MAIN STAIRS SHOW LOCATIONS OF SCUTTLE ACCESS OR PULL DOWN STAIRS ON 2ND FLOOR PLAN FOR PULL DOWN STAIRS. MECHANICAL ACCESS IN ATTIC OPENING SHALL BE LARGE ENOUGH TO ALLOW REMOVAL OF THE LARGEST APPLIANCE. THE ROUGH OPENING SHALL BE 30"X54" AND THE STAIR LOAD CAPACITY SHALL BE A MINIMUM OF 350 POUNDS CAPACITY. PER IRC M1305.13.

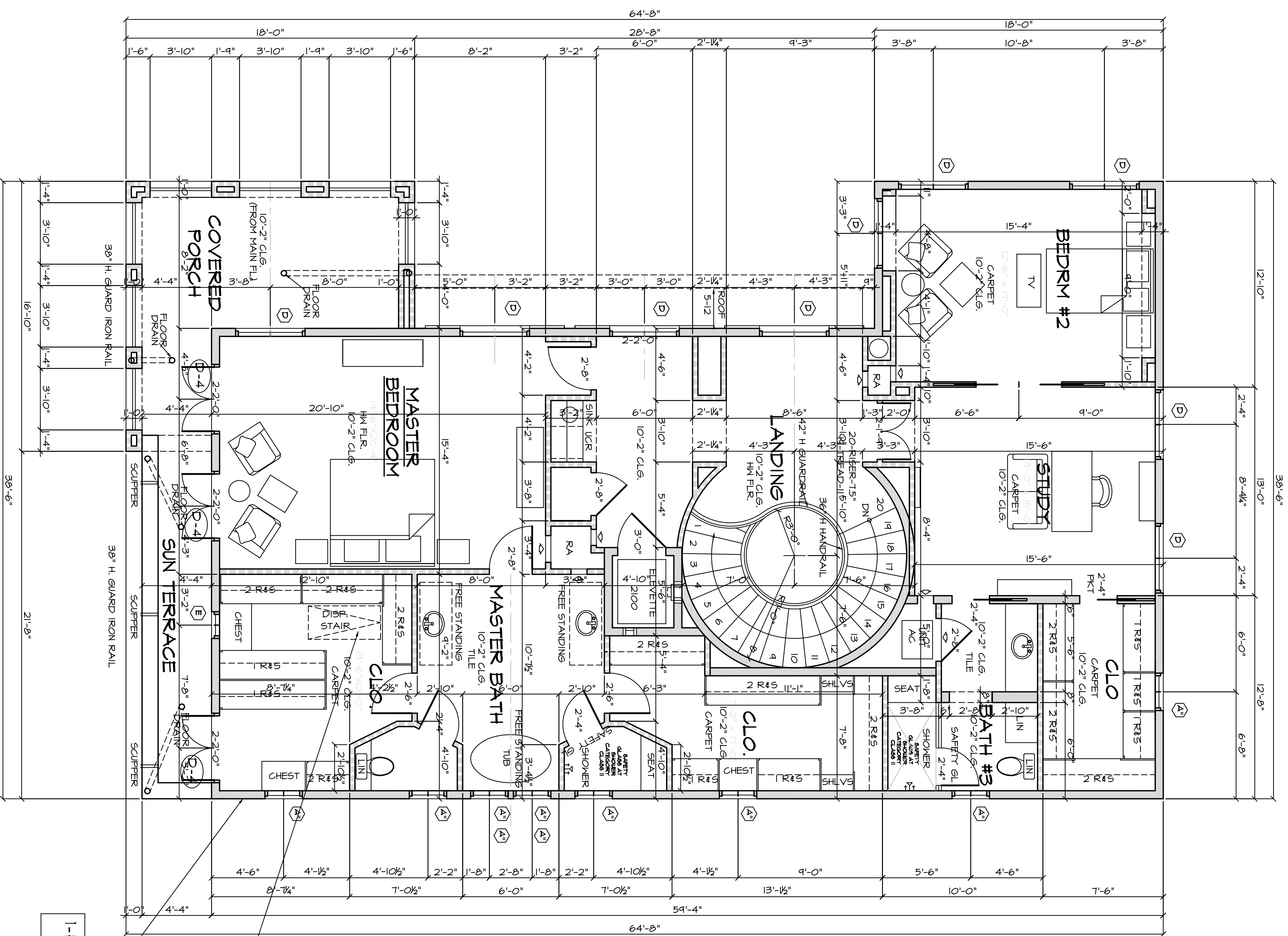

WALL TYPE SCHEDULE:

- ===== 2x4 STUDS AT 16" O.C.
- ===== 2x4 STUDS AT 16" O.C.
- ===== 2x4 STUDS AT 16" O.C. WITH BRICKSTONE LEDGE
- ===== MIN. 2x6 STUDS AT 16" O.C.
- ===== MIN. 2x6 STUDS AT 16" O.C. WITH BRICKSTONE LEDGE

THIRD FLOOR PLAN

1/4"=1'-0"
ALL ANGLES 45° UNL.

SCUTTLE DOOR TO BE IN NON-COMBUSTIBLE MATERIAL AND FIRE RATED PER THE CITY OF HOUSTON CODE WOOD 51

1-HR FIRE RATED WALL DESIGN NO. U305

SOUTHAMPTON HOMES

DESIGNS
by Robert Dancie

7322 Southwest Fwy.,
Suite 800
Houston, Texas 77074
(713) 270-8225
fax (713) 270-8389

Revisions	By
7-4-08	HL

Drawn by: HL
Date: 10-08-04
Job No.: 04-857-A
Sheet: **2.2**